

O R D I N A N C E No. 88

AN ORDINANCE ANNEXING TO THE CITY OF DUNES CITY, LANE COUNTY, OREGON, CERTAIN CONTIGUOUS TERRITORY PURSUANT TO THE PROVISIONS OF ORS 222.120.

The City of Dunes City does Ordain as follows:

I.

WHEREAS all of the owners of the following described real property, to-wit:

Government Lot 7, Section 3, Township 20 South, Range 12 W.W.M.,
Lane County, Oregon,

and filed with the City Recorder of the City of Dunes City, Oregon a written consent that such real property be annexed to the City of Dunes City, Oregon,

WHEREAS said real property is contiguous territory to the City of Dunes City, Oregon, and

WHEREAS, Ordinance No. 5 was heretofore passed, initiating the annexation of said contiguous territory, calling a hearing and directing that notice be given thereon, which Ordinance was duly passed by the Common Council of the City of Dunes City on September 14, 1964, and

WHEREAS the hearing called for on the proposed annexation was held on Monday, October 5, 1964 at the meeting room in Clearwaters Cafe on Woahink Lake, in Dunes City, Oregon at 8:00 o'clock p. m. Pacific Daylight Time of said day, at which time any objections or remonstrances with reference to said proposed annexation were considered by the Common Council of Dunes City, Oregon, and having heard any such objections and remonstrances with reference to said proposed annexation, the Council is of the considered opinion that said above described contiguous territory should be annexed to the City of Dunes City, Lane County, Oregon.

NOW THEREFORE,

II.

The above described contiguous territory to the City of Dunes City, Lane County, Oregon, is hereby declared to be annexed to the City of Dunes City, Lane County, Oregon, and the City Recorder is directed forthwith to make and submit to the Secretary of the State of Oregon a copy of this ordinance, together with a copy of the written consent of the owners of all of the above described territory here annexed to the City of Dunes City, Oregon, and also a copy of the ordinance declaring that no election shall be required in said annexation proceeding within said City of Dunes City, Oregon. The City Recorder is also directed to submit

copies of this ordinance to the Director of the Department of Records and Elections, Lane County Court House, Eugene, Oregon, together with a map or plat of said territory, and to the Lane County Assessor and to the Lane County Surveyor, Eugene, Oregon.

Passed by the Common Council this 5th day of October, 1964.

Approved by the Mayor this 5th day of October, 1964.

Phillip D. Himmel, Mayor

ATTEST:

Phyllis Jones, City Recorder

T 20 S. R. 12 W. W.M.
LANE COUNTY
1/4-2000'

20 12
6 INDEX
1/4

THIS MAP IS TO ASSIST LOCATING
PROPERTY. THE COMPANY ASSUMES
NO LIABILITY FOR INACCURACIES.

See Map 20 12

PACIFIC OCEAN

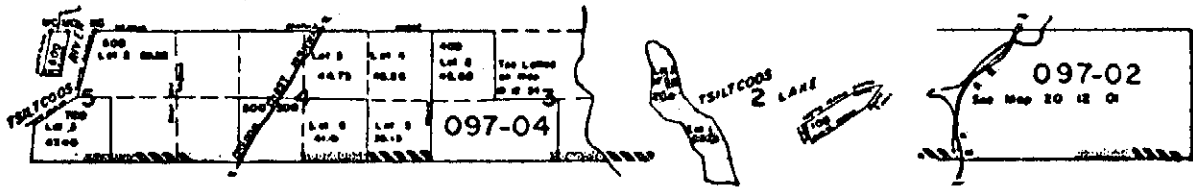

DOUGLAS COUNTY LINE

Dropped
300

T 20 S. R. 12 W. W.M.
LANE COUNTY
1:2000'

20 12
& INDEX

THIS MAP IS TO ASSIST LOCATING
PROPERTY. THE COMPANY ASSUMES
NO LIABILITY FOR INACCURACIES.

See Map 19 12

